

PROPOSED DESIGN



SIGN/MESSAGE BOARD

PAINT COLORS:



BASE:  
GLIDDEN: THYME  
(70YY 46/160)

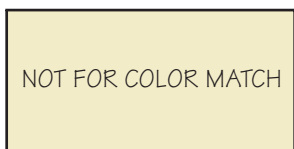

TRIM:  
GLIDDEN: PARCHMENT  
(40YY 70/138)

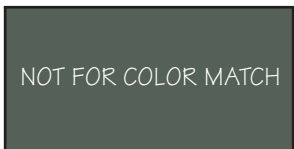

TRIM:  
GLIDDEN: PIN OAK  
(10GY 11/142)

NOTE: The Illinois MAIN STREET Program, through the Illinois Historic Preservation Agency, has provided this free design assistance to qualified property/ business owners in the officially designated MAIN STREET project areas. The rendering on this sheet is a conceptual view of the facade renovation based on information supplied to the staff architect. Should obscured architectural details or problems be revealed during the work, the local project manager and/or the staff architect should be consulted.



**ILLINOIS MAIN STREET**  
OFFICE OF LIEUTENANT GOVERNOR BOB KUSTRA  
*Architectural Services:* Illinois Historic Preservation Agency  
1 Old State Capitol Plaza/Springfield, Illinois 62701/217-782-9336

WINFIELD  
ELEMENTARY SCHOOL  
05150 WINFIELD ROAD  
WINFIELD, ILLINOIS

EAST ELEVATION  
NOT TO SCALE

Drawn By: BSL	Project No.: 9722
Date: 5 - 97	Sheet: Of: 1 2

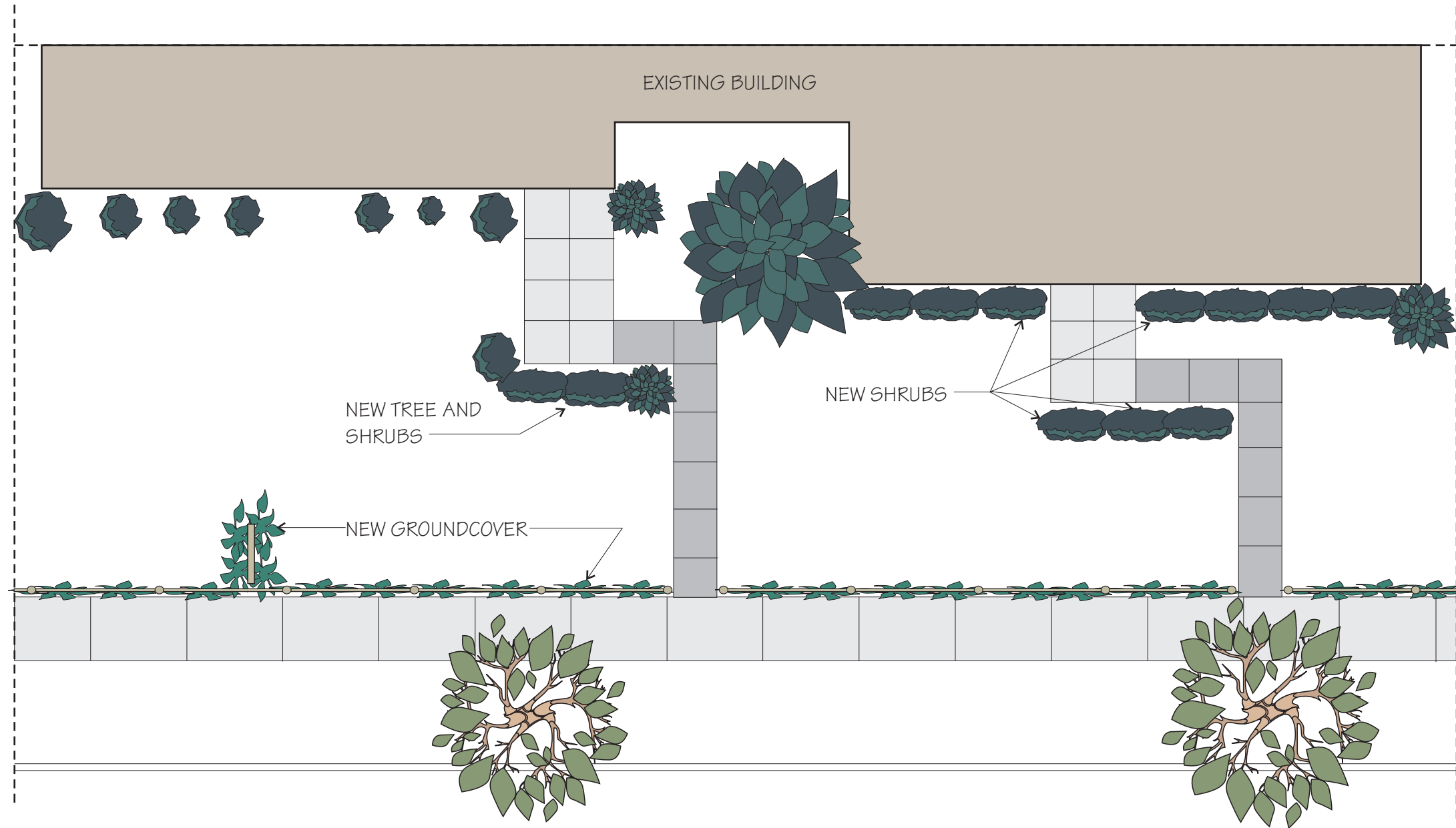

**LEGEND:**

-  EXISTING SIDEWALK
-  NEW SIDEWALK
-  GROUND COVER/  
LOW MAINTENANCE PLANT
-  EVERGREEN SHRUB
-  EVERGREEN TREE
-  DECIDUOUS TREE
-  SIGN/MESSAGE BOARD
-  GUARDRAIL

PROPOSED SITE PLAN

NOTE: The Illinois MAIN STREET Program, through the Illinois Historic Preservation Agency, has provided this free design assistance to qualified property/ business owners in the officially designated MAIN STREET project areas. The rendering on this sheet is a conceptual view of the facade renovation based on information supplied to the staff architect. Should obscured architectural details or problems be revealed during the work, the local project manager and/or the staff architect should be consulted.



**ILLINOIS MAIN STREET**

OFFICE OF LIEUTENANT GOVERNOR BOB KUSTRA  
*Architectural Services:* Illinois Historic Preservation Agency  
 1 Old State Capitol Plaza/Springfield, Illinois 62701/217-782-9336

WINFIELD  
 ELEMENTARY SCHOOL  
 05150 WINFIELD ROAD  
 WINFIELD, ILLINOIS

EAST ELEVATION  
 NOT TO SCALE

Drawn By: BSL	Project No.: 9722
Date: 5 - 97	Sheet: Of: 2 2