

ARCHITECTURAL ASSESSMENT - Web Links:

Historic Status

National Register of Historic Places

www.iowahistory.org/historic-preservation/national-register-of-historic-places/properties-in-iowa.html

Iowa Survey of cultural resources

www.iowahistory.org/historic-preservation/statewide-inventory-and-collections/index.html

Seismic Hazard Map:

<http://earthquake.usgs.gov/earthquakes/states/iowa/hazards.php>

Sanborn Maps

www.statelibraryofiowa.org/services/online-resources/resources/sanborn-login

Flood Insurance Rate Maps FIRM

www.fema.gov/hazard/map/flood.shtm

Environmental Assessment:

Environmental Assessment Process

A guide to the Phase I Environmental Assessment

<http://www.enterprisefoundation.org/resources/dss/singlefam/sf&24&in&nc&ss&lg&rin&rnc&ucpsc18.htm>

Asbestos

Iowa Division of Labor

www.iowaworkforce.org/labor/asbestos.htm

Lead Paint

US EPA

www.epa.gov/lead/pubs/renovation.htm

Iowa Dept. of Public Health

www.epa.gov/lead/pubs/renovation.htm

Lead Paint and Historic Buildings (free publication)

www.illinoishistory.gov/PS/leadpaint.htm

Building Codes

Fire Ratings of Archaic Materials and Assemblies

www.huduser.org/portal/publications/destech/fire.html

Fire Code Product

Intumescent Paint - Fire Free 88 www.firefree.com/allProducts.php

Eco Equation:

National Trust Life Cycle Assessment (LCA) Study on Building Reuse

www.preservationnation.org/issues/sustainability/green-lab/valuing-building-reuse.html

<http://tinyurl.com/nthpqvbr>

Parks Canada Study on Energy Efficient Renovation

<http://tinyurl.com/24eda2n>

Natural Light and Air Requirements for Residential Use

(International Building Code 2000)

General. "Every space intended for human occupancy shall be provide with natural light by means of exterior glazed openings..." 1204.1

Natural Light: The minimum net glazed area shall not be less than 8 percent of the floor area of the room served. (1204.2)

Adjoining Spaces "a room is considered a portion of an adjoining room where one half of the common wall is open...and provides an area not less than 10% of the floor area of the interior room or 25 sq. ft., whichever is greater."

Natural Ventilation 1202.4

Natural ventilation of an occupied space shall be through windows, doors, louvers, or other natural openings to the outdoors. 1202.4

Ventilation Area Required: The minimum vented area to the outdoors shall be **4 percent** of the floor area being ventilated. 1202.4.1

Adjoining Spaces (borrowed ventilation): The unobstructed opening to the adjoining room shall be at least 8 percent of the floor area of the room or space, but not less than **25 sq. ft.** The ventilation openings to the outdoors shall be based upon the total floor area being ventilated. 1202.4.1.1

Bathrooms ...shall be mechanically ventilated according to the Int. Mechanical Code. 1202.4.2.1

Sample Light and Air Worksheet

Calculation showing maximum habitable room area using available windows

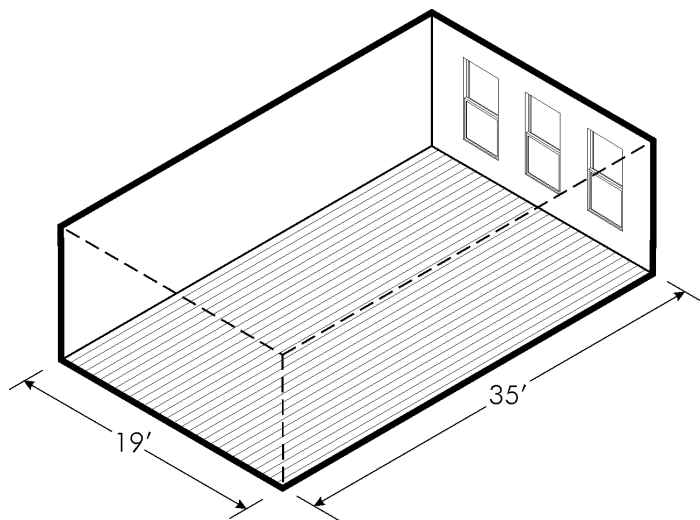

EXAMPLE

WINDOW AREA

3' X 6' = 18 sq. ft. per window
x 3 windows
54 sq. ft. of window glazing
27 sq. ft. of vent opening

MAXIMUM ALLOWABLE ROOM SIZE

54 sq. ft. is 8 % of
675 sq. ft.

Room is actually 19 x 35 = 665 sq. ft.
 $665 \leq 675 \rightarrow$ the room is under the maximum allowable size.