



EXISTING CONDITIONS



PROPOSED SCHEME WITH AWNING

AWNING:

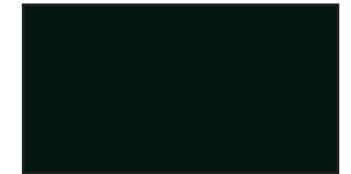

SUNBRELLA:

SPRUCE  
(4656)

PAINT COLORS:

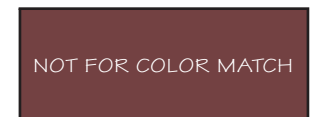

BRICK:

SHERWIN WILLIAMS: CARRIAGE DOOR  
(SW 2294)

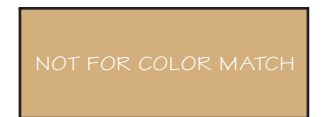

TRIM:

SHERWIN WILLIAMS: OAKLEDGE  
(SW 2204)

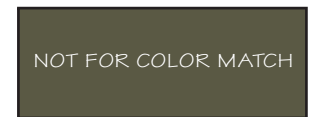

DETAILS:

SHERWIN WILLIAMS: VINEYARD GREEN  
(SW 2244)

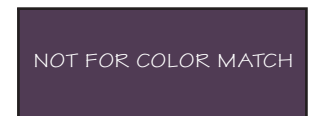

ACCENTS:

SHERWIN WILLIAMS: GRAPE  
(SW 2702)

NOTE: The Illinois MAIN STREET Program, through the Illinois Historic Preservation Agency, has provided this free design assistance to qualified property/business owners in the officially designated MAIN STREET project areas. The rendering on this sheet is a conceptual view of the facade renovation based on information supplied to the staff architects. Should obscured architectural details or problems be revealed during the work, the local project manager and/or the staff architects should be consulted.



ILLINOIS MAIN STREET

ILLINOIS HISTORIC PRESERVATION AGENCY  
500 East Madison Street Springfield, Illinois 62701 217.782.4836  
DEPARTMENT OF COMMERCE AND COMMUNITY AFFAIRS

CHRIST CENTERED STORE

337 COURT STREET, PEKIN

ELEVATION

Not to Scale

Drawn By	Project Number
CLM	200070
Date	Sheet Of
2/01	1 2



EXISTING CONDITIONS

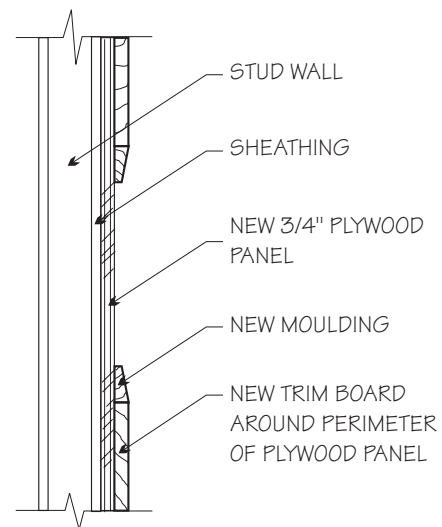

TYPICAL PANELING DETAIL



PROPOSED SCHEME WITHOUT AWNING

AWNING:



SUNBRELLA:

SPRUCE  
(4656)

PAINT COLORS:

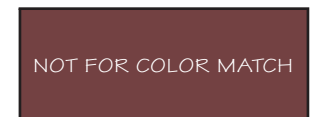

BRICK:

SHERWIN WILLIAMS: CARRIAGE DOOR  
(SW 2294)



TRIM:

SHERWIN WILLIAMS: OAKLEDGE  
(SW 2204)

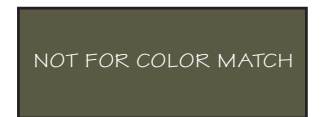

DETAILS:

SHERWIN WILLIAMS: VINEYARD GREEN  
(SW 2244)

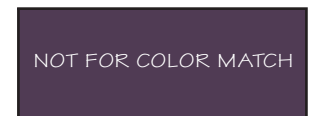

ACCENTS:

SHERWIN WILLIAMS: GRAPE  
(SW 2702)

NOTE: The Illinois MAIN STREET Program, through the Illinois Historic Preservation Agency, has provided this free design assistance to qualified property/business owners in the officially designated MAIN STREET project areas. The rendering on this sheet is a conceptual view of the facade renovation based on information supplied to the staff architects. Should obscured architectural details or problems be revealed during the work, the local project manager and/or the staff architects should be consulted.



ILLINOIS MAIN STREET

ILLINOIS HISTORIC PRESERVATION AGENCY  
500 East Madison Street Springfield, Illinois 62701 217.782.4836  
DEPARTMENT OF COMMERCE AND COMMUNITY AFFAIRS

CHRIST CENTERED STORE

337 COURT STREET, PEKIN

ELEVATION

Not to Scale

Drawn By	Project Number
CLM	200070
Date	Sheet Of
2/01	2 2