



EXISTING CONDITIONS



PROPOSED DESIGN
NORTH ELEVATION

AWNING:



SUNBRELLA:

BLACK FOREST FANCY
(#4923)

PAINT COLORS:

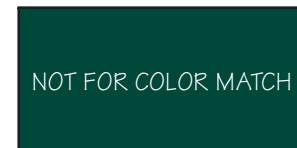

NOT FOR COLOR MATCH

BASE:

ICI: OLDE HUNTER
(1094)

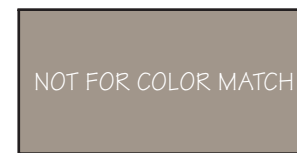

NOT FOR COLOR MATCH

TRIM:

ICI: TOMORROW'S TAUPE
(369)

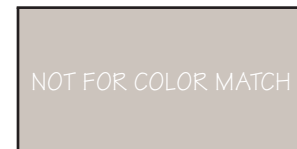

NOT FOR COLOR MATCH

TRIM:

ICI: PRISM WHITE
(659)

NOTE: The Illinois MAIN STREET Program, through the Illinois Historic Preservation Agency, has provided this free design assistance to qualified property/business owners in the officially designated MAIN STREET project areas. The rendering on this sheet is a conceptual view of the facade renovation based on information supplied to the staff architects. Should obscured architectural details or problems be revealed during the work, the local project manager and/or the staff architects should be consulted.



ILLINOIS MAIN STREET

ILLINOIS HISTORIC PRESERVATION AGENCY
1 Old State Capitol Plaza Springfield, Illinois 62701 217.782.4836
DEPARTMENT OF COMMERCE AND COMMUNITY AFFAIRS

132 West Main Street
Belleville, IL

ELEVATION

Not to Scale

Drawn By:
CLM

Project No.:
9951

Date:
5/00

Sheet: Of:
1 5



EXISTING CONDITIONS



PROPOSED DESIGN
NORTH ELEVATION

AWNING:



SUNBRELLA:
BLACK FOREST FANCY
(#4923)

PAINT COLORS:

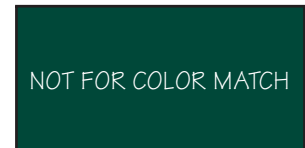

BASE:
ICI: OLDE HUNTER
(1094)

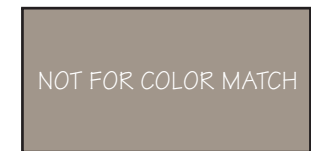

TRIM:
ICI: TOMORROW'S TAUPE
(369)

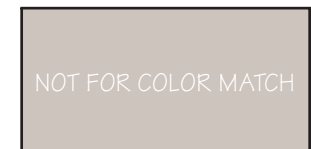

TRIM:
ICI: PRISM WHITE
(659)

NOTE: The Illinois MAIN STREET Program, through the Illinois Historic Preservation Agency, has provided this free design assistance to qualified property/business owners in the officially designated MAIN STREET project areas. The rendering on this sheet is a conceptual view of the facade renovation based on information supplied to the staff architects. Should obscured architectural details or problems be revealed during the work, the local project manager and/or the staff architects should be consulted.



ILLINOIS MAIN STREET

ILLINOIS HISTORIC PRESERVATION AGENCY
1 Old State Capitol Plaza Springfield, Illinois 62701 217.782.4836
DEPARTMENT OF COMMERCE AND COMMUNITY AFFAIRS

132 West Main Street
Belleville, IL

ELEVATION

Not to Scale

Drawn By:
CLM

Project No.:
9951

Date:
5/00

Sheet: Of:
2 5



EXISTING CONDITIONS

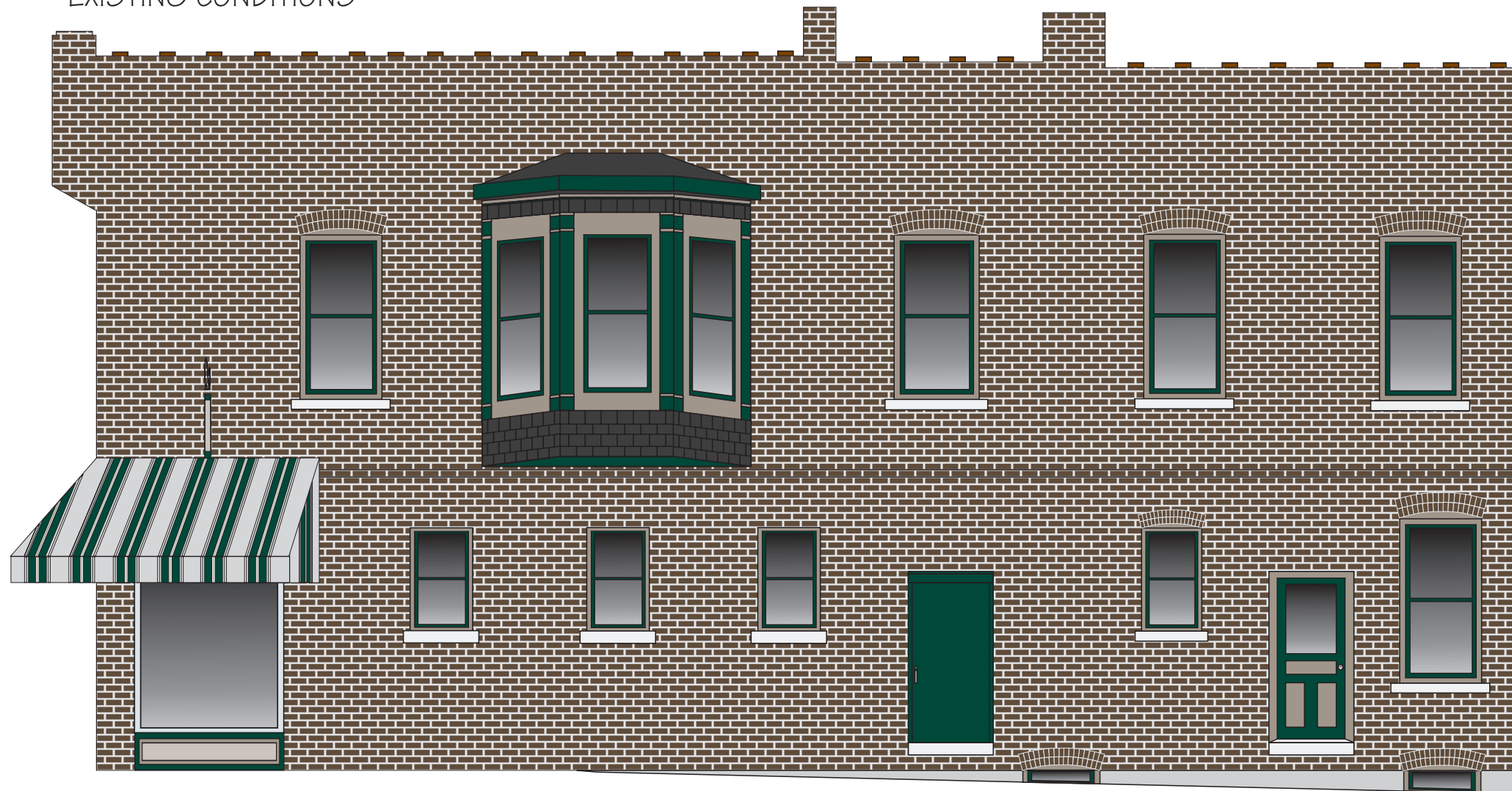

PROPOSED DESIGN
WEST ELEVATION

AWNING:



SUNBRELLA:

BLACK FOREST FANCY
(#4923)

PAINT COLORS:

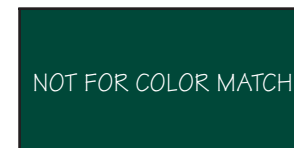

BASE:

ICI: OLDE HUNTER
(1094)

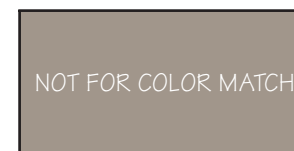

TRIM:

ICI: TOMORROW'S TAUPE
(369)

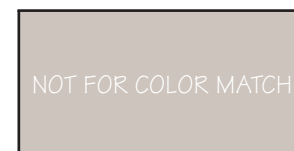

TRIM:

ICI: PRISM WHITE
(659)

NOTE: The Illinois MAIN STREET Program, through the Illinois Historic Preservation Agency, has provided this free design assistance to qualified property/business owners in the officially designated MAIN STREET project areas. The rendering on this sheet is a conceptual view of the facade renovation based on information supplied to the staff architects. Should obscured architectural details or problems be revealed during the work, the local project manager and/or the staff architects should be consulted.



ILLINOIS MAIN STREET

ILLINOIS HISTORIC PRESERVATION AGENCY
1 Old State Capitol Plaza Springfield, Illinois 62701 217.782.4836
DEPARTMENT OF COMMERCE AND COMMUNITY AFFAIRS

132 West Main Street
Belleville, IL

ELEVATION

Not to Scale

Drawn By:
CLM

Date:
5/00

Project No.:
9951

Sheet: Of:
3 5



EXISTING CONDITIONS



PROPOSED DESIGN
SOUTH ELEVATION

AWNING:

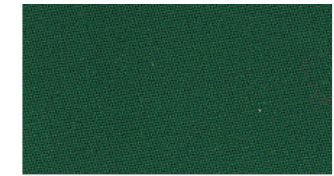

SUNBRELLA:
Forest Green
(#4637)

PAINT COLORS:

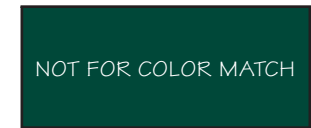

BASE:
ICI: OLDE HUNTER
(1094)



TRIM:
ICI: TOMORROW'S TAUPE
(369)



TRIM:
ICI: PRISM WHITE
(659)

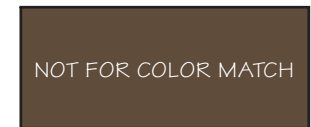

UTILITIES:
ICI: GOOD EARTH
(137)

NOTE: The Illinois MAIN STREET Program, through the Illinois Historic Preservation Agency, has provided this free design assistance to qualified property/business owners in the officially designated MAIN STREET project areas. The rendering on this sheet is a conceptual view of the facade renovation based on information supplied to the staff architects. Should obscured architectural details or problems be revealed during the work, the local project manager and/or the staff architects should be consulted.



ILLINOIS MAIN STREET

ILLINOIS HISTORIC PRESERVATION AGENCY
1 Old State Capitol Plaza Springfield, Illinois 62701 217.782.4836
DEPARTMENT OF COMMERCE AND COMMUNITY AFFAIRS

132 West Main Street
Belleville, IL

ELEVATION

Not to Scale

Drawn By:
CLM

Project No.:
9951

Date:
5/00

Sheet: Of:
4 5

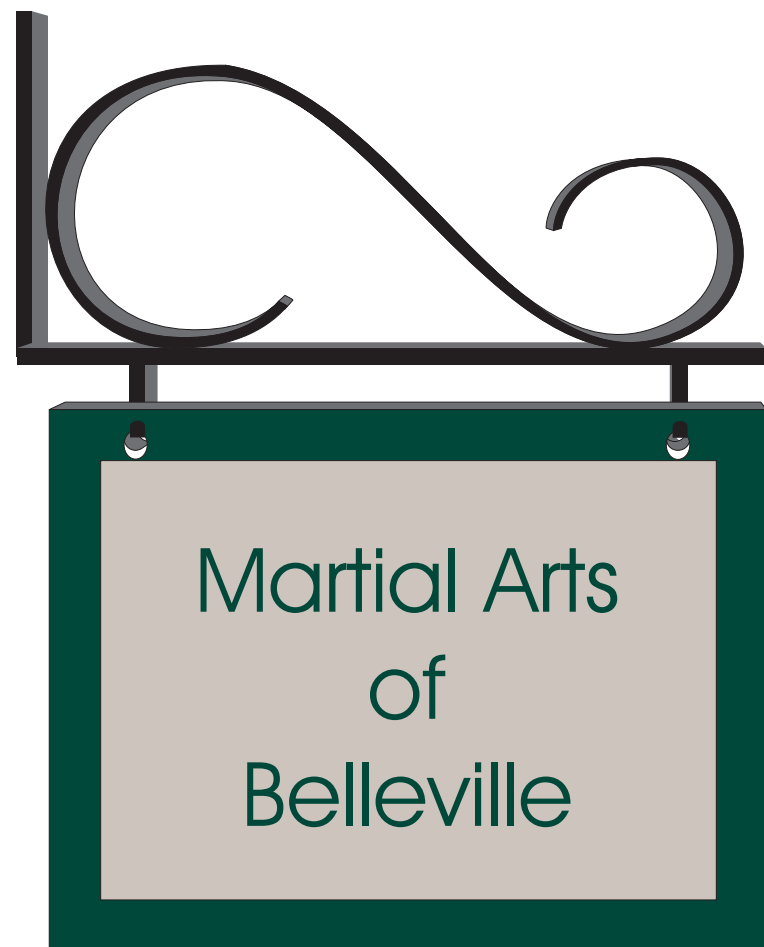

PAINT COLORS:

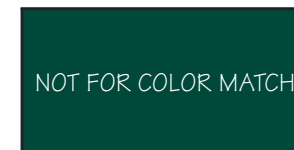

BASE:

ICI: OLDE HUNTER
(1094)

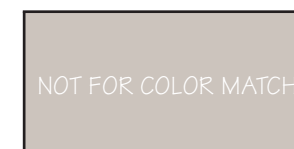

TRIM:

ICI: PRISM WHITE
(659)

PRELIMINARY SIGN DESIGN

NOTE: The Illinois MAIN STREET Program, through the Illinois Historic Preservation Agency, has provided this free design assistance to qualified property/business owners in the officially designated MAIN STREET project areas. The rendering on this sheet is a conceptual view of the facade renovation based on information supplied to the staff architects. Should obscured architectural details or problems be revealed during the work, the local project manager and/or the staff architects should be consulted.



ILLINOIS MAIN STREET

ILLINOIS HISTORIC PRESERVATION AGENCY
1 Old State Capitol Plaza Springfield, Illinois 62701 217.782.4836
DEPARTMENT OF COMMERCE AND COMMUNITY AFFAIRS

132 West Main Street
Belleville, IL

ELEVATION

Not to Scale

Drawn By:
CLM

Date:
5/00

Project No.:
9951

Sheet: Of:
5 5